

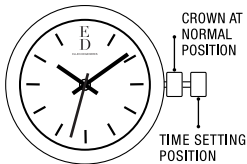

ELLEN DEGENERES

WATCH INSTRUCTIONS &
LIFETIME LIMITED WARRANTY



SETTING THE TIME

1. Pull the Crown out to the Time Setting Position.
2. Turn the Crown in either direction to set the Hour and Minute hands to the desired time.
3. Push the Crown back in to the Normal Position to re-engage time keeping.

NOTE: Never pull the Crown when the watch is wet.

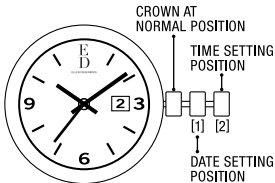

SETTING THE TIME

1. Pull the Crown out to the 2nd Position.
2. Turn the Crown in either direction to set the Hour and Minute hands to the desired time.
3. Push the Crown back in to the Normal Position to re-engage time keeping.

NOTE: Never pull the Crown when the watch is wet.

SETTING THE DATE

1. Pull the Crown out to the 1st Position.
2. Turn the Crown clockwise to set the Date.
3. After the Date has been set, push the Crown back in to the Normal Position to re-engage time keeping.

*NOTE: *If the Date and/or the Day of the week is set between the hours of around 9:00 PM and 2:00 AM, they may not advance on the following day.*

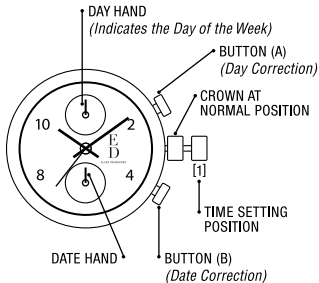

SETTING THE TIME

1. Pull the Crown out to the 1st Position when the Second Hand is at the 12 o'clock position. The Second Hand will stop.

NOTE: Never pull the Crown when the watch is wet.

2. Turn the Crown until the desired time is obtained. Be sure to take the AM/PM into consideration.
3. When setting the Minute Hand, advance it 4 to 5 minutes ahead of the desired time and then turn it back to the exact time.
4. Push the Crown back in to the Normal Position to re-engage time keeping.

SETTING THE DATE AND DAY OF THE WEEK

1. Day Correction: press the Button A; the Day Hand advances to the next day.
2. Date Correction: press the Button B; the Date Hand advances one day.
3. While setting the Date and the Day Hands, check that they move properly in one day increments.

NOTE: Do not set the Date and the Day Hands between the hours of 9:00 PM and 4:00 AM; otherwise, they may not advance properly. It is necessary to adjust the Date on the first day after a 30-day month and in February.

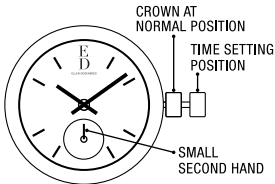

SETTING THE TIME

1. Pull the Crown out to the Time Setting Position.
2. Turn the Crown in either direction to set the Hour and Minute hands to the desired time.
3. Push the Crown back in to the Normal Position to re-engage time keeping.

NOTE: Never pull the Crown when the watch is wet.

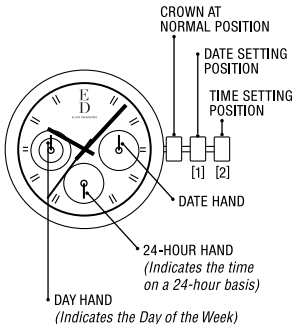

SETTING THE TIME

1. Pull the Crown out to the 2nd Position and rotate the Crown clockwise or counter-clockwise until the desired Time and Day are obtained.
2. Push the Crown back in to the Normal Position to re-engage time keeping.

NOTE: Never pull the Crown when the watch is wet.

SETTING THE DATE

1. Pull the Crown out to the 1st position.
2. Turn the Crown counter-clockwise to set the Date.
3. After the Date has been set, push the Crown back in to the Normal Position to re-engage time keeping.

NOTE: The 24 hour (Military Time) adjusts automatically when the Time is set. Do not set the Date between the hours 9:00PM and 4:00AM; otherwise, the Date may not advance properly.

WATER RESISTANCE

If your watch is water resistant, the watch is tested to be water resistant to 3-5 atmospheres (100-165 feet).

NOTE: Over time, the gaskets of the case may become worn and reduce the water resistance of the watch. A trained specialist should change the gaskets and the O-ring each time the battery is changed. To avoid any unwanted condensation, watches of all specifications (water resistant or not) should not be exposed to extreme temperatures such as cold or heat.

CHANGING THE BATTERY

Replace batteries when the watch becomes slow or does not operate, the readout darkens or does not appear or the backlight fails. Replace with same or equivalent.

NOTE: Battery change should be performed by a qualified technician who should also check the condition of the gaskets at the same time.

BATTERIES ARE NOT COVERED UNDER WARRANTY.

DIAGRAMS FOR ADJUSTABLE BRACELET WATCHES

1. CLASP EXTENDER

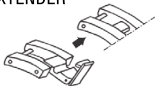

2. ONE SCREW SYSTEM

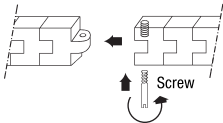

3. TWO SCREW SYSTEM

Screw in one at a time.

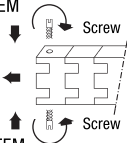
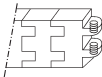

4. CONNECTION SYSTEM

Use 2 screwdrivers. Hold one side steady before turning the screw.

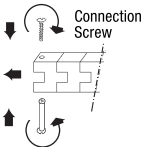

5. METAL INSERT

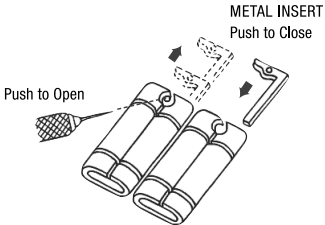

6. HAIRCLIP PIN

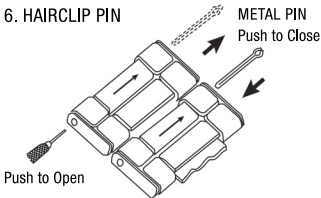

Turn over the watch to **look** for arrows on the underside of the **links**, showing you which way you need to push the pin out of the link. Use a pin remover tool to push out the "Hair Clip Pin" from the hole located on the side of the link. After the links are removed, simply **follow** these steps in reverse to re-assemble the bracelet.

7. PIN & TUBE 1



Side view "B"
of Link



Side view "A"
of Link

Push to Open

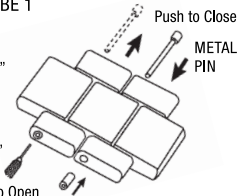

Check the side edge of the watch link to determine which side of the link is "A" or "B". Take a pin remover tool and push out the pin from the hole located on side "B". After the desired links are removed, simply follow these steps in reverse to re-assemble the bracelet.

8. PIN & TUBE 2

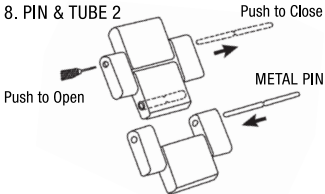

In order to adjust links for this watch construction, you must switch the pin on the tool kit to the longest pin (approximately 10mm long) found under the tool kit. Then use the pin remover tool to push out the pins from either side of the links. After the desired links are removed, simply follow these steps in reverse to re-assemble the bracelet.

9. SLIDING BAR

TOP OF BAND

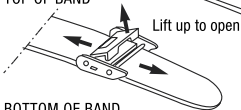

BOTTOM OF BAND

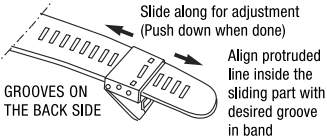

10. FOLD-OVER BUCKLE

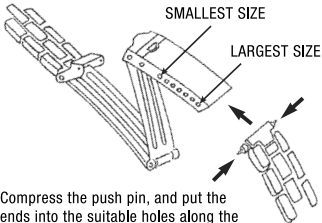

Compress the push pin, and put the ends into the suitable holes along the buckle.

MESH BAND ADJUSTMENT

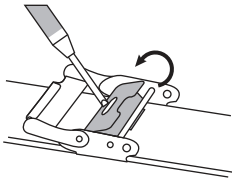

1. Place the tip of a **small screwdriver** or **adjustment tool** into the **slot** on the **clasp**. Gently exert pressure down on the screwdriver and pry the top portion of the **clasp** open.

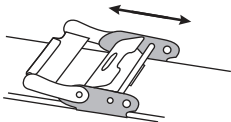

2. Slide the clasp up or down the mesh strap to adjust the band for the size of your wrist. When the proper fit for your wrist has been obtained, align the back of the clasp with the corresponding groove in the mesh watch strap.

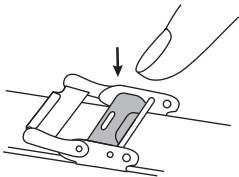

3. Press the **slotted clasp** back down to securely close it.

Dear Customer:

Help your watch/jewelry retailer protect our environment by properly recycling the button cell battery in your watch. Professional jewelers and watch retailers are best equipped to replace the battery in your watch without damage to the watch case and movement inside. They have the specialized tools and experience to do the job right. Inexperienced people can scar the case and damage the water resistant seal – voiding your warranty. It is important to recycle your watch battery in an environmentally safe way. Watch batteries contain very small amounts of mercury, which is required to prevent corrosion of the battery and damage to your watch. There is no danger to you or your watch from the mercury because it is in the sealed battery. But you need to recycle your watch battery properly. Your

professional watch/jewelry retailer is the best person to do this for you. These professionals collect used batteries and recycle them through licensed waste management companies.

Do our environment and your watch a favor. Ask your watch/jewelry professional to replace your battery when it expires.

**USE OUR NATIONWIDE SERVICE CENTERS.
YOU CANNOT RETURN WATCH FOR
SERVICE WHERE IT WAS PURCHASED.**

If your watch requires cleaning, lubrication, battery changing, or needs a crystal replaced, ED by Ellen DeGeneres approved Service Centers are available in your area. These repair facilities use ED by Ellen DeGeneres parts and components to assure quality and future performance. Free estimates are available in advance, should you need servicing or repairs not covered under the warranty. Repairs covered under the warranty may require proof of purchase, so retain the purchase receipt.

TO RETURN YOUR WATCH FOR SERVICING:

Please call (718) 482-4195 or email servicedept@egluck.com for a listing of all approved and authorized stations and locations.

NOTE: YOUR WATCH CANNOT BE RETURNED TO THE PLACE OF PURCHASE.

Carefully pack your watch in a sturdy box (do not send in a gift box for same will not be returned) and mail to the nearest approved authorized service station. Because of possible loss, we recommend that you insure your watch, return receipt requested, when using the mail. If you do not receive a receipt within a reasonable time, start a tracer through the originating post office. Never include a special watch band or any other article of personal value in your shipment.

LIMITED WARRANTY

This ED by Ellen DeGeneres Watch is warranted to you, the owner, for your lifetime against all defects in material or workmanship. This warranty does not apply to normal wear and tear or abuse and excludes batteries, case, strap, crystal, or bracelet. In the event of a defect or malfunction of the movement within this period it will be repaired or replaced, at our option, provided that it is returned prepaid with a check or money order for \$9.95 to cover the cost of handling and return postage. (This is not a repair charge.) DO NOT SEND CASH. No additional charge will be made unless additional servicing is necessary for reasons beyond our control such as accident, misuse, neglect or replacement of parts not warranted is required such as case, crystal, strap, bracelet or batteries in which event a moderate charge will be made.

The movement of any timepiece requires periodic cleaning/timing which is not a defect and, as such not warranted. After one year from the date of purchase each cleaning/timing will be performed as required without charging a fee in excess of the specified \$9.95 handling charge. The above remedy is exclusive. ED by Ellen DeGeneres shall not be liable for any incidental or consequential damages. Should any other part of your watch require repair, please use our Service Center for quick and inexpensive repairs on your watch. This warranty gives you specific legal rights and you may also have other rights which may vary from state to state. Some states do not allow limitations on how long an implied warranty lasts, or the exclusion or limitation of incidental or consequential damages, so the above limitations and

exclusions may not apply to you. In the event of a problem with warranty service or performance, you may be able to go to Small Claims Court, a State Court or a Federal District Court.

NOTES:

***SPECIFICATIONS SUBJECT TO CHANGE WITHOUT
PRIOR NOTICE FOR PRODUCT IMPROVEMENT,
DESIGN MAY VARY DEPENDING ON THE MODEL.**

Updated 1/2019

