

ANNE KLEIN

**PANOORIN ANG INSTRUCTION MANUAL
& 2 YEAR LIMITED WARRANTY**

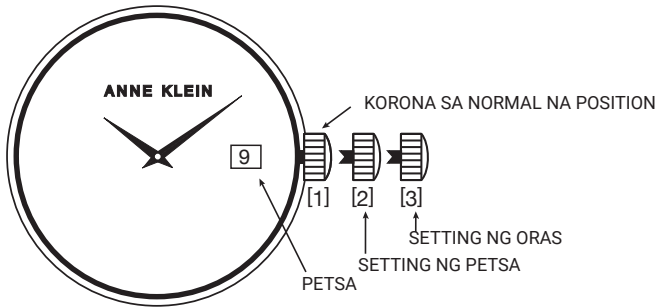

ANNE KLEIN

9

KORONA SA NORMAL NA POSITION

[1]

[2]

[3]

PETA

SETTING NG PETA

SETTING NG ORAS

SETTING NG ORAS

Hilahin ang Crown hanggang sa huminto ito (posisyon '3'). Titigil ang pangalawang kamay. I-rotate ang Crown sa alinmang direksyon hanggang sa makuha ang nais na oras. Itulak pabalik ang Crown sa lahat ng paraan (posisyon '1') upang muling makipag-ugnayan sa pagpapanatili ng oras. Magsisimulang gumalaw ang second hand.

TANDAAN: Huwag kailanman hilahin ang Korona kapag basa ang relo.

SETTING NG ORAS, ARAW AT PETA

Kung ang iyong relo ay may Petsa ng Araw at Petsa ng Bintana, hilahin ang Crown palabas sa posisyon na '2' at iikot ang Crown sa magkabilang direksyon hanggang sa ang petsa ay ipinapakita ang araw bago ang gustong Petsa. Hilahin ang Crown hanggang sa (posisyon '3') at i-on ang Crown para mag-advance ng oras. Kapag naabot ang hatinggabi, ang Petsa ay uusad sa nais na Petsa. Patuloy na iikot ang Korona hanggang sa makuha ang nais na oras. Itulak pabalik ang Crown hanggang sa huminto ito (posisyon '1') upang muling makipag-ugnay sa pagpapanatili ng oras.

WATER RESISTANCE

Kung ang iyong relo ay hindi tinatablan ng tubig, ang relo ay sinusubok na lumalaban sa tubig sa 3-5 na atmospheres (100-165 talampakan).

TANDAAN: *Sa paglipas ng panahon, ang mga gasket ng case ay maaaring masira at mabawasan ang water resistance ng relo. Dapat palitan ng isang sinanay na espesyalista ang mga gasket at ang O-ring sa tuwing pinapalitan ang baterya. Upang maiwasan ang anumang hindi gustong condensation, ang mga relo ng lahat ng mga detalye (water resistant o hindi) ay hindi dapat malantad sa matinding temperatura gaya ng lamig o init.*

PAGPAPALIT NG BATTERY

Palitan ang mga baterya kapag ang relo ay naging mabagal o hindi gumagana, ang readout ay dumidilim o hindi lumitaw o ang backlight ay nabigo. Palitan ng pareho o katumbas.

TANDAAN: *Ang pagpapalit ng baterya ay dapat gawin ng isang kwalipikadong technician na dapat ding suriin ang kondisyon ng mga gasket sa parehong oras.*

ANG MGA BATERYA AY HINDI SAKOP SA ILALIM NG WARRANTY.

DIAGRAMS PARA SA ADJUSTABLE BRACELET WATCHES

1. CLASP EXTENDER

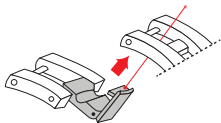

2. ISANG SCREW SYSTEM

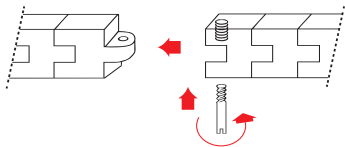

3. DALAWANG SCREW SYSTEM

Mag-screw in nang paisa-isa.

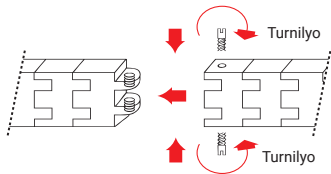

4. CONNECTION SYSTEM

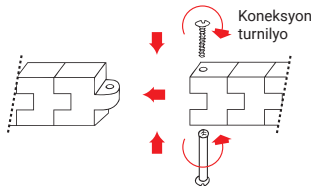

Gumamit ng 2 screwdriver. Hawakan nang matatag ang isang gilid bago buksan ang tornilyo.

5. METAL INSERT

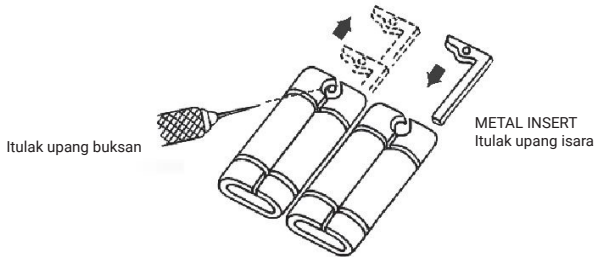

6. PIN CLIP NG BUHOK

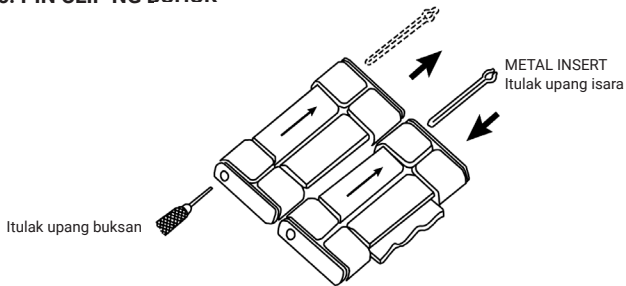

Ibaliktad ang relo upang maghanap ng mga arrow sa ilalim ng mga link, na nagpapakita sa iyo kung aling paraan ang kailangan mong itulak ang pin palabas ng link. Gumamit ng pin remover tool para itulak palabas ang “Pin ng Clip ng Buhok” mula sa butas na matatagpuan sa gilid ng link. Pagkatapos maalis ang mga link, sundin lamang ang mga hakbang na ito nang pabaliktad upang muling i-assemble ang pulseras.

7. PIN at TUBE 1



Ang side view na "B" ng Link



Ang side view na "A" ng Link

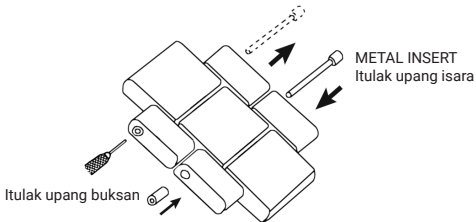

Suriin ang gilid na gilid ng link ng relo upang matukoy kung aling bahagi ng link ang "A" o "B". Kumuha ng pin remover tool at itulak ang pin mula sa butas na matatagpuan sa gilid na "B". Pagkatapos maalis ang mga gustong link, sundin lang ang mga hakbang na ito nang pabaliktad upang muling i-assemble ang bracelet.

8. PIN at TUBE 2

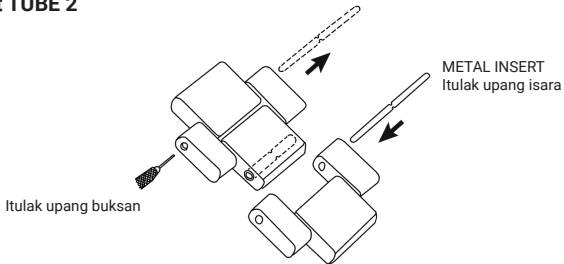

Upang maisaayos ang mga link para sa paggawa ng relo na ito, dapat mong ilipat ang pin sa tool kit sa pinakamahabang pin (humigit-kumulang 10mm ang haba) na makikita sa ilalim ng tool kit. Pagkatapos ay gamitin ang pin remover tool upang itulak ang mga pin mula sa magkabilang gilid ng mga link. Pagkatapos maalis ang mga gustong link, sundin lang ang mga hakbang na ito nang pabaliktad upang muling i-assemble ang bracelet.

9. SLIDING BAR

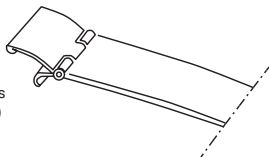
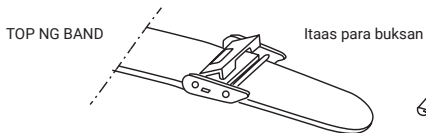

Mag-slide para sa pagsasaayos
(itulak pababa kapag tapos na)

IBABA NG BAND

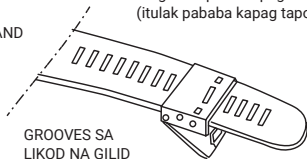

Ihanay ang nakausli na linya
sa loob ng sliding part na
may gustong uka sa banda

10. FOLD-OVER BUCKLE

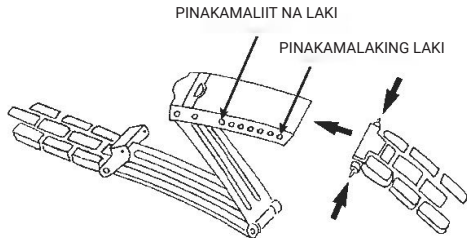

I-compress ang push pin, at ilagay ang mga dulo sa angkop na mga butas sa kahabaan ng buckle.

MESH BAND ADJUSTMENT

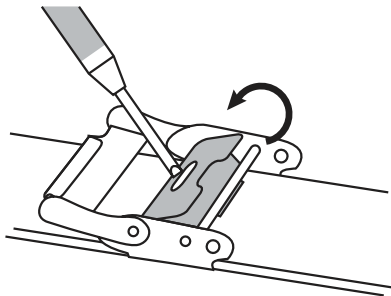

1 . Ilagay ang dulo ng maliit na screwdriver o adjustment tool sa slot sa clasp. Dahan-dahang idiin ang screwdriver at buksan ang itaas na bahagi ng clasp.

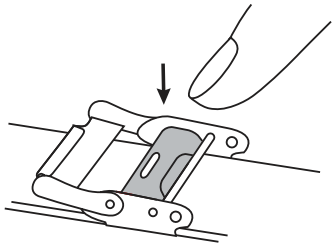
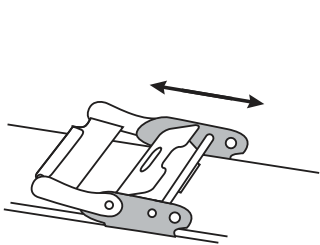

2 . I-slide ang clasp pataas o pababa sa mesh strap upang ayusin ang banda para sa laki ng iyong pulso. Kapag nakuha na ang tamang akma para sa iyong pulso, ihanay ang likod ng clasp sa corresponding groove sa mesh watch strap.

3 . Pindutin ang slotted clasp pabalik pababa upang secure na isara ito.

1. PARA I-UPDATE ANG IYONG BOXSET:

PAGPAPALIT NG STRAPS

Upang alisin ang Strap, ilagay ang relo na nakaharap sa isang malambot at patag na ibabaw. I-slide ang Strap Lever sa kaliwa at hilahin ang Strap palayo sa relo.

PARA INSERT ANG BAGONG STRAP

Itakda ang Strap Pin sa Left Pin Groove. I-slide ang Strap Lever sa kaliwa. I-align ang Strap para “mag-click” ang Right Pin sa Right Pin Groove kapag binitawan ang Lever.

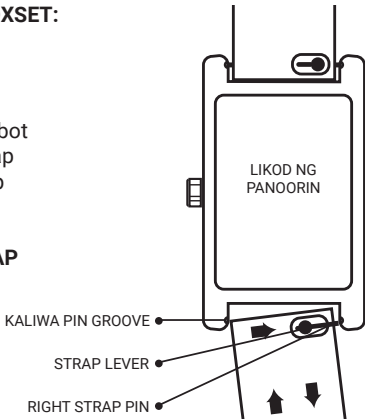

2. PARA I-UPDATE ANG IYONG BOXSET:

PAGPAPALIT NG BEZEL

Upang alisin ang Bezel, paikutin ang Bezel nang pakaliwa hanggang sa maiangat mo ang Bezel mula sa relo. Ilagay ang bagong Bezel sa ibabaw ng Watch Case at paikutin ang Bezel pakanan hanggang sa masikip ang Bezel.

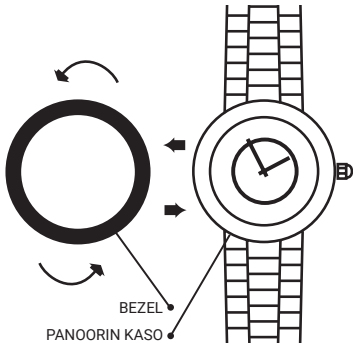

Mahal na Customer:

Tulongan ang iyong retailer ng relo/alahas na protektahan ang aming kapaligiran sa pamamagitan ng wastong pag-recycle ng button na baterya ng cell sa iyong relo. Ang mga propesyonal na alahas at mga retailer ng relo ay may pinakamainam na kagamitan upang palitan ang baterya sa iyong relo nang walang pinsala sa lalagyan ng relo at paggalaw sa loob. Mayroon silang mga espesyal na tool at karanasan upang gawin ang trabaho nang tama. Maaaring peklatin ng mga taong walang karanasan ang kaso at masira ang water resistant seal – mapapawalang-bisa ang iyong warranty. Mahalagang i-recycle ang iyong baterya ng relo sa paraang ligtas sa kapaligiran. Ang mga baterya ng relo ay naglalaman ng napakaliit na halaga ng mercury, na kinakailangan upang maiwasan ang kaagnasan ng baterya at masira ang iyong relo. Walang panganib sa iyo o sa iyong relo mula sa mercury dahil ito ay nasa selyadong baterya. Ngunit kailangan mong i-recycle nang maayos ang baterya ng iyong relo. Ang iyong propesyonal na retailer ng relo/alahas ay ang pinakamahusay na tao para gawin ito para sa iyo. Kinokolekta ng mga propesyonal na ito ang mga ginamit na baterya at

nire-recycle ang mga ito sa pamamagitan ng mga lisensyadong kumpanya sa pamamahala ng basura.

Gawin ang aming kapaligiran at ang iyong panonood ng isang pabor. Hilingin sa iyong propesyonal sa relo/alahas na palitan ang iyong baterya kapag nag-expire na ito.

Nangangailangan ng (1) silver oxide (1.55 volt) na bateryang Kasama

UPANG IBALIK ANG IYONG RELO PARA SA PAGLILINGKOD: Ibalik ITO SA ANNE KLEIN WATCH CO. O SA ISANG AUTHORIZED SERVICE CENTER; HINDI ITO DAPAT IBABALIK SA LUGAR NA BINILI.

Maingat na ilagay ang iyong relo sa isang matibay na kahon (huwag ipadala sa isang kahon ng regalo para hindi na ibabalik) at ipadala sa:

**ANNE KLEIN WATCHES
6015 Little Neck Parkway
Little Neck, NY 11362
ATTN: Service Dept.
Tel: +1 718 482-4195
Email: servicedept@egluck.com**

AUTHORIZED SERVICE CENTERS

**Clarity Ltd.
Flat A-B, 12/F,
Sing Mei Industrial Building
29-37 Kwai Wing Road
Kwai Chung, N.T. Hong Kong
Tel: 852.2424.2211
Fax: 852.2424.2077
Email: senrice@egc-clarity.com**

**Baode Watch (Shen Zhen) Co. Ltd
3/F, 56 Mei Bao Road, Xin Qiao Tang
Ind. Zone, Da Lang, Longhua
District, Shenzhen, China 518109
Tel: 86 755-28112770**

Dahil sa posibleng pagkawala, inirerekomenda namin na iseguro mo ang iyong relo, hiniling na resibo sa pagbabalik, kapag ginagamit ang mail. Kung ang iyong relo ay nangangailangan ng paglilinis, pagpapadulas, pagpapalit ng baterya, o kailangan ng isang kristal na palitan, ang mga naaprubahang Service Center ng ANNE KLEIN ay maaaring available sa iyong lugar. Ang mga pasilidad sa pagkukumpuni na ito ay gumagamit ng mga piyesa at sangkap ng ANNE KLEIN upang matiyak ang kalidad at pagganap sa hinaharap. Ang mga libreng pagtatantya ay magagamit nang maaga, kung kailangan mo ng serbisyo o pagkukumpuni na hindi sakop sa ilalim ng warranty. Ang mga pagsasaayos na sakop sa ilalim ng warranty ay maaaring mangailangan ng patunay ng pagbili, kaya panatilihin ang resibo ng pagbili. Para sa karagdagang impormasyon tungkol sa mga inaprubahang Service Station at lokasyon ng ANNE KLEIN, mangyaring tawagan ang mga Service Center na nakalista sa itaas.

2 YEAR LIMITED WARRANTY

Ang ANNE KLEIN na relo na ito ay ginagarantiyahan sa iyo, ang may-ari, sa loob ng 2 taon laban sa lahat ng mga depekto sa materyal o pagkakagawa. Ang warranty na ito ay hindi nalalapat sa normal na pagkasira o pag-abuso at hindi kasama ang mga baterya, case, strap, kristal, o pulseras. Kung sakaling magkaroon ng depekto o malfunction ng kilusan sa loob ng panahong ito ito ay aayusin o papalitan ayon sa aming pagpipilian. Walang karagdagang singil na gagawin maliban kung kailangan ang karagdagang serbisyo para sa mga kadahilanang hindi natin kontrolado tulad ng aksidente, maling paggamit, kapabayaang o pagpapalit ng mga piyesang hindi ginagarantiya ay kinakailangan tulad ng case, kristal, strap, pulseras o mga baterya kung saan magkakaroon ng katamtamang singil. ginawa.

Ang nabanggit na lunas ay eksklusibo. Hindi mananagot si ANNE KLEIN para sa anumang insidente o kinahinatnang pinsala. Kung anumang iba pang bahagi ng iyong relo ay nangangailangan ng pagkumpuni, mangyaring gamitin ang aming Mga Service Center para sa mabilis at murang pag-aayos sa iyong relo. Ang warranty na ito ay nagbibigay sa iyo ng mga partikular na legal na karapatan at maaari ka ring magkaroon ng iba pang mga karapatan na maaaring mag-iba sa bawat bansa.

EU Representative: 24hour-AR
Van Nelleweg 1
3044 BC Rotterdam
The Netherlands
compliance@24hour-ar.com

UK Representative: 24hour-AR
15 Beaufort Court Admirals Way
Canary Wharf, London
United Kingdom E14 9XL
compliance@24hour-ar.com

*** ANG MGA ESPESIPIKASYON NA DAPAT MAGBABAGO NG WALANG
PAUNANG PAUNAWA PARA SA PAGPAPABUTI NG PRODUKTO, MAAARING
MAG-IBA ANG DISENYO DEPENDE SA MODEL.**





ANNE KLEIN

**WATCH INSTRUCTIONS &
2-YEAR LIMITED WARRANTY**

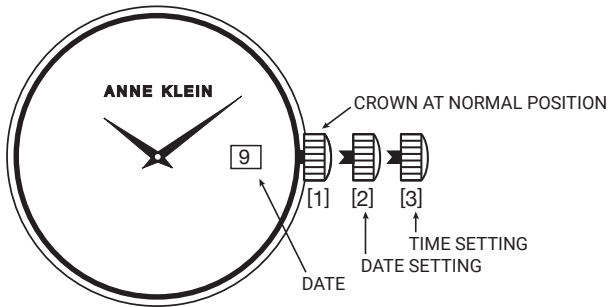

SETTING THE TIME

Pull out Crown all the way until it stops (position '3'). The second hand will stop. Rotate the Crown in either direction until desired time is obtained. Push Crown back in all the way (position '1') to re-engage time keeping. Second hand will begin to move.

NOTE: Never pull the Crown when the watch is wet.

SETTING THE TIME, DAY AND DATE

If your watch has a Date or a Day and Date Window, pull the Crown out to position '2' and turn the Crown in both directions until the Date showing is the day before the desired Date. Pull out Crown all the way (position '3') and turn the Crown to advance time. When midnight is reached, the Date will advance to the desired Date. Continue to turn the Crown until desired time is obtained. Push the Crown back in all the way until it stops (position '1') to re-engage time keeping.

WATER RESISTANCE

If your watch is water resistant, the watch is tested to be water resistant to 3-5 atmospheres (100-165 feet).

NOTE: Over time, the gaskets of the case may become worn and reduce the water resistance of the watch. A trained specialist should change the gaskets and the O-ring each time the battery is changed. To avoid any unwanted condensation, watches of all specifications (water resistant or not) should not be exposed to extreme temperatures such as cold or heat.

CHANGING THE BATTERY

Replace batteries when the watch becomes slow or does not operate, the readout darkens or does not appear or the backlight fails. Replace with same or equivalent.

NOTE: Battery change should be performed by a qualified technician who should also check the condition of the gaskets at the same time.

BATTERIES ARE NOT COVERED UNDER WARRANTY.

DIAGRAMS FOR ADJUSTABLE BRACELET WATCHES

1. CLASP EXTENDER

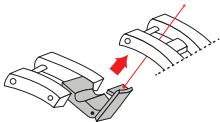

2. ONE SCREW SYSTEM

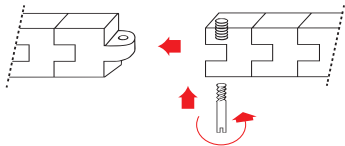

3. TWO SCREW SYSTEM

Screw in one at a time

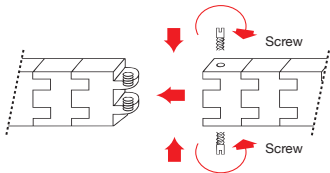

4. CONNECTION SYSTEM

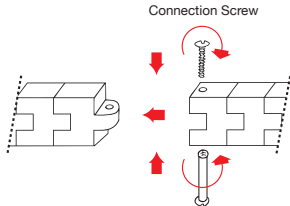

Use 2 screwdrivers. Hold one side steady before turning the screw.

5. METAL INSERT

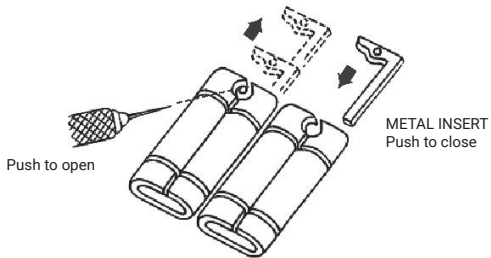

6. HAIRCLIP PIN

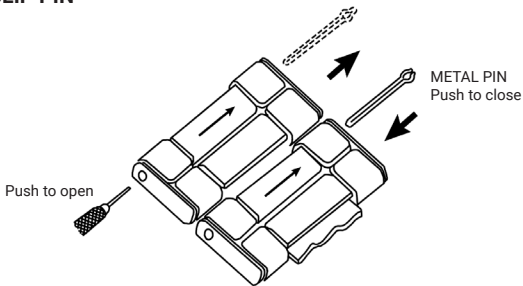

Turn over the watch to look for arrows on the underside of the links, showing you which way you need to push the pin out of the link. Use a pin remover tool to push out the "hair clip pin" from the hole located on the side of the link. After the links are removed, simply follow these steps in reverse to re-assemble the bracelet.

7. PIN & TUBE 1



Side view "B" of Link



Side view "A" of Link

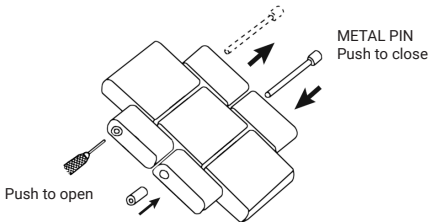

Check the side edge of the watch link, to determine which side of the link is "A" or "B". Take a pin remover tool and push out the pin from the hole located on side "B". After the desired links are removed, simply follow these steps in reverse to re-assemble the bracelet.

8. PIN & TUBE 2

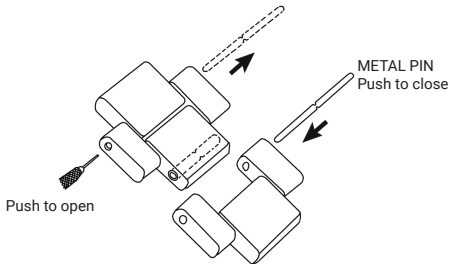

In order to adjust links for this watch construction, you must switch the pin on the tool kit to the longest pin (approximately 10mm long) found under the tool kit. Then use the pin remover tool to push out the pins from either side of the links. After the desired links are removed, simply follow these steps in reverse to re-assemble the bracelet.

9. SLIDING BAR

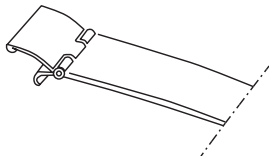
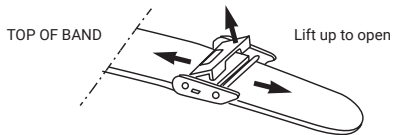

Slide along for adjustment
(Push down when done)

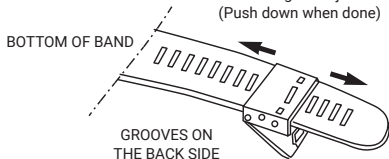

Align protruded line inside the sliding part with desired groove in band

10. FOLD-OVER BUCKLE

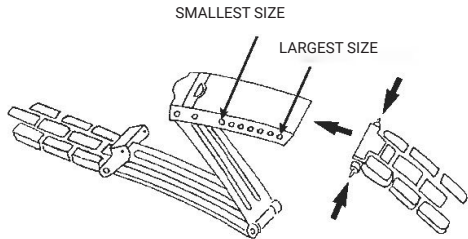

Compress the push pin, and put the ends into the suitable holes along the buckle.

11. MESH BAND ADJUSTMENT

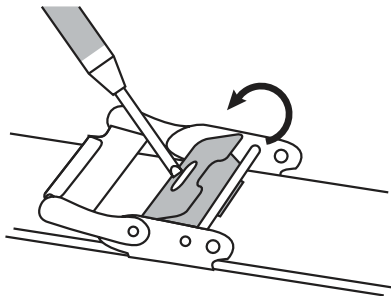

1. Place the tip of a small screwdriver or adjustment tool into the slot on the clasp. Gently exert pressure down on the screwdriver and pry the top portion on the clasp open.

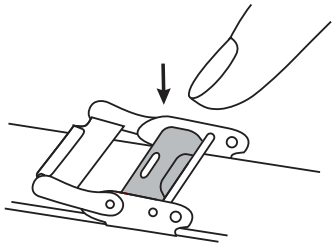
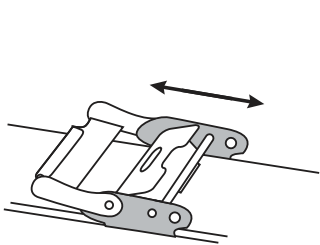

2. Slide the clasp up or down the mesh strap to adjust the band for the size of your wrist. When the proper fit for your wrist has been obtained, align the back of the clasp with the corresponding groove in the mesh watch strap.
3. Press the slotted clasp back down to securely close it.

1. TO UPDATE YOUR BOXSET:

CHANGING THE STRAPS

To remove the Strap, place the watch face down on a soft, flat surface. Slide the Strap Lever to the left and pull the Strap away from the watch.

TO INSERT THE NEW STRAP

Set Strap Pin into the Left Pin Groove. Slide the Strap Lever to the left. Align the Strap so the Right Pin “clicks” into the Right Pin Groove when the Lever is released.

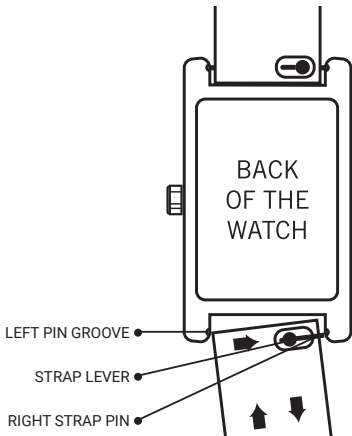

2. TO UPDATE YOUR BOXSET:

CHANGING THE BEZEL

To remove the Bezel, turn the Bezel counterclockwise until you can lift the Bezel from the watch. Place the new Bezel over the Watch Case and turn the Bezel clockwise until the Bezel is tight.

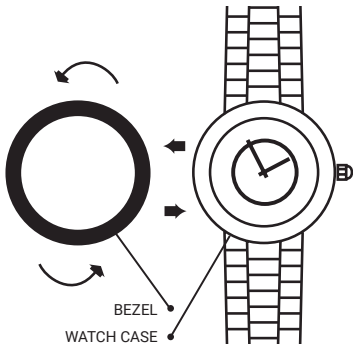

3. TO UPDATE YOUR BOXSET:

CHANGING THE BEZEL AND BRACELET

To remove the Bezel, turn the Bezel counterclockwise until you can lift the Bezel from the watch.

Hold the Watch upright and unhook the Bracelet. Hook on the new Bracelet.

Place the new Bezel over the Watch Case and turn the Bezel clockwise until the Bezel is tight.

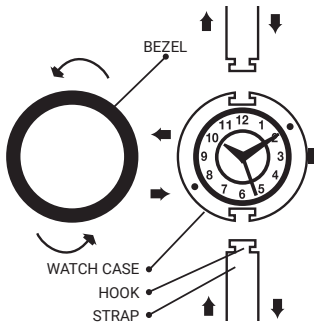

Dear Customer:

Help your watch/jewelry retailer protect our environment by properly recycling the button cell battery in your watch. Professional jewelers and watch retailers are best equipped to replace the battery in your watch without damage to the watch case and movement inside. They have the specialized tools and experience to do the job right. Inexperienced people can scar the case and damage the water resistant seal – voiding your warranty. It is important to recycle your watch battery in an environmentally safe way. Watch batteries contain very small amounts of mercury, which is required to prevent corrosion of the battery and damage to your watch. There is no danger to you or your watch from the mercury because it is in the sealed battery. But you need to recycle your watch battery properly. Your professional watch/jewelry retailer is the best person to do this for you. These professionals collect used batteries and recycle them through licensed waste management companies.

Do our environment and your watch a favor. Ask your watch/jewelry professional to replace your battery when it expires.

Requires (1) silver oxide)(1.55 volt) battery included

**TO RETURN YOU WATCH FOR SERVICING:
RETURN IT TO ANNE KLEIN CO. OR TO AN AUTHORIZED SERVICE CENTER;
IT SHOULD NOT BE RETURNED TO PLACE OF PURCHASE.**

Carefully pack you watch in a sturdy box (do not send in a gift box for same will not be returned) and mail to:

ANNE KLEIN WATCHES

6015 Little Neck Parkway
Little Neck, NY 11362

ATTN: Service Dept.

Tel: +1 718 482-4195

Email: servicedept@egluck.com

Clarity Ltd.

Flat A- B, 12/F,
Sing Mei Industrial Building
29-37 Kwai Wing Road
Kwai Chung, N.T. Hong Kong

Tel: 852.2424.2211

Fax: 852.2424.2077

Email: service@egc-clarity.com

Because of possible loss, we recommend that you insure your watch, return receipt requested, when using the mail. If your watch requires cleaning, lubrication, battery changing, or needs a crystal replaced, ANNE KLEIN approved Service Centers may be available in your area. These repair facilities use ANNE KLEIN parts and components to assure quality and future performance. Free estimates are available in advance, should you need servicing or repairs not covered under the warranty. Repairs covered under the warranty may require proof of purchase, so retain the purchase receipt. For further information regarding ANNE KLEIN approved Service Stations and locations, please call the Service Centers listed above.

2 YEAR LIMITED WARRANTY

This Anne Klein Watch is warranted to you, the owner, for 2 years against all defects in material or workmanship. This warranty does not apply to normal wear and tear or abuse and excludes batteries, case, strap, crystal, or bracelet. In the event of a defect or malfunction of the movement within this period it will be repaired or replaced, at our option. No additional charge will be made unless additional servicing is necessary for reasons beyond our control such as accident, misuse, neglect or replacement of parts not warranted is required such as case, crystal, strap, bracelet or batteries in which event a moderate charge will be made.

The aforementioned remedy is exclusive. ANNE KLEIN shall not be liable for any incidental or consequential damages. Should any other part of your watch require repair, please use our Service Centers for quick and inexpensive repairs on your watch. This warranty gives you specific legal rights and you may also have other rights which may vary from country to country.

EU Representative: 24hour-AR
Van Nelleweg 1
3044 BC Rotterdam
The Netherlands
compliance@24hour-ar.com

UK Representative: 24hour-AR
15 Beaufort Court Admirals
Way Canary Wharf, London
United Kingdom E14 9XL
compliance@24hour-ar.com

* SPECIFICATIONS SUBJECT TO CHANGE WITHOUT PRIOR NOTICE FOR PRODUCT
IMPROVEMENT, DESIGN MAY VARY DEPENDING ON THE MODEL.

