

**ANNE KLEIN**

手表和 2 年保修期说明书

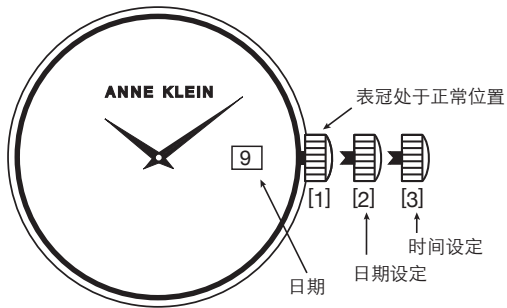

## 设置时间

将表冠完全拉出，直至其停止（位置“3”）。秒针将停止。向任一方向旋转表冠，直到获得所需的时间。将表冠完全推回（位置“1”）以重新计时。秒针将开始移动。

*注意：手表潮湿时切勿拉动表冠。*

## 设置时间、星期和日期

如果您的手表有时间、星期和日期窗口，请将表冠拉出至位置“2”，并向两个方向旋转表冠，直到显示的日期为所需日期的前一天。将表冠完全拉出（位置“3”）并旋转表冠以推进时间。到达午夜时分，日期将推进至所需日期。继续旋转表冠，直到获得所需时间。将表冠完全推回，直至其停止（位置“1”）以重新开始计时。

## 防水性能

如果您的手表具有防水功能，则该手表经过测试可防水 3-5 个大气压（100-165 英尺）。

*注意：随着时间的推移，表壳的垫圈可能会磨损，从而降低手表的防水性。每次更换电池时，应由训练有素的专业人员更换垫圈和 O 形圈。为避免任何不必要的冷凝，所有规格的手表（防水或非防水）都不应暴露在极端温度下，例如寒冷或的极端温度。*

## 更换电池

当手表走时缓慢或不走动、读数变暗或不显示、背光灯失效时，请更换电池。更换相同或同等电池。

**注意：**电池更换应由合格的技术人员进行，同时还应检查垫圈的状况。电池不在保修范围内。

## 可调式手链手表图表

### 1. 卡扣延长器

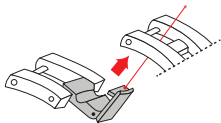

### 2. 单螺钉系统

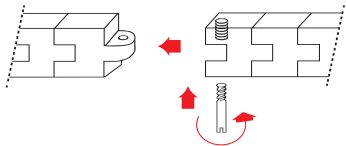

### 3. 双螺杆系统

每次拧入一颗螺丝。

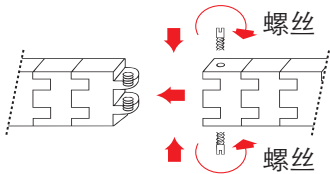

### 4. 连接系统

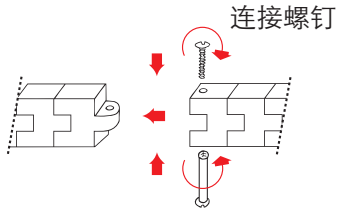

使用 2 把螺丝刀。拧动螺丝之前先握住一侧，使其稳定。

## 5. 金属嵌件

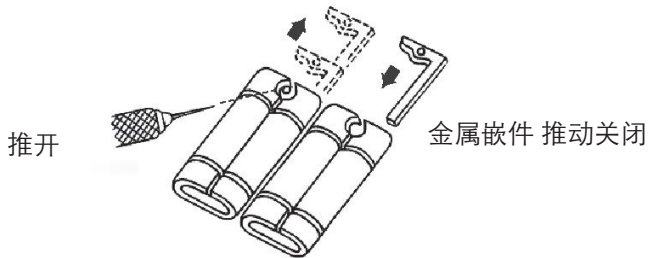

## 6.发夹销钉

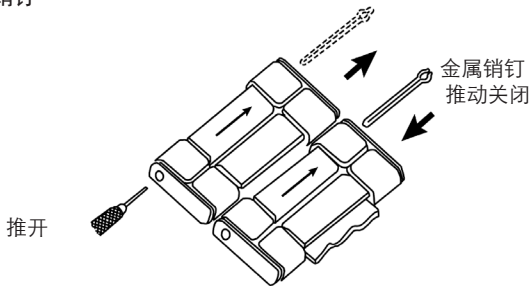

翻转手表，查看链节下方的箭头，箭头会显示需要将销钉从链节中推出的方向。使用销钉拆卸工具将“发夹销钉”从链节侧面的孔中推出。链节拆卸后，只需按相反顺序执行这些步骤即可重新组装表链。

## 7. 销钉和管套1

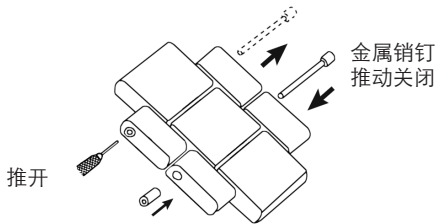

检查手表链节的侧边，确定链节的哪一侧是“A”或“B”。使用销钉拆卸工具，将销钉从位于“B”侧的孔中推出。拆卸所需链节后，只需按相反步骤操作即可重新组装表链。

## 8. 销钉和管套 2

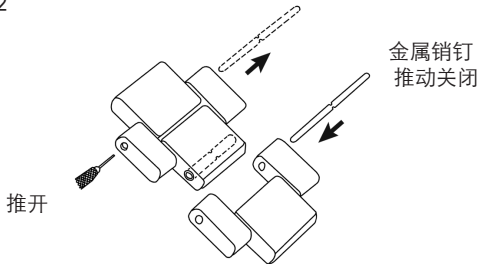

为了调整此手表结构的链节，您必须切换将工具箱中的最长销钉（约 10 毫米长）插入工具箱下方。然后使用销钉拆卸工具将销钉从链环的两侧推出。拆卸所需链环后，只需按相反步骤操作即可重新组装手链。

## 9. 滑动条

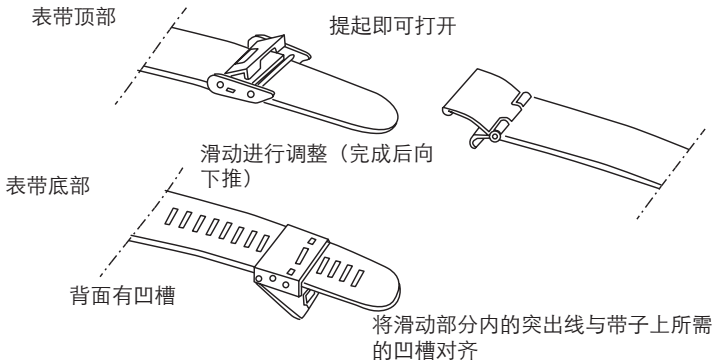

## 10. 折叠扣

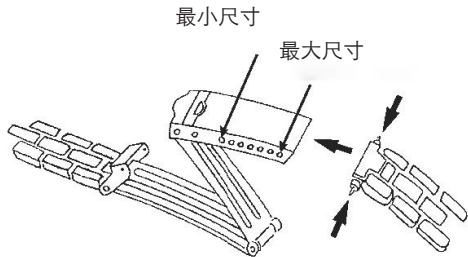

压缩图钉，并将其末端插入沿着扣环的合适孔中。

## 网格带调节

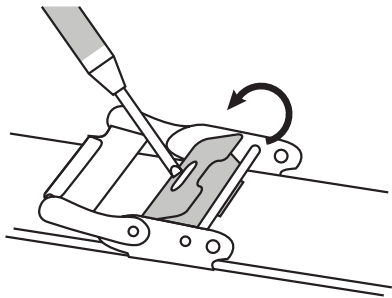

- 1.将小型螺丝刀或调节工具的尖端插入扣环上的插槽。 轻轻地用力按下螺丝刀，将扣环的顶部撬开。

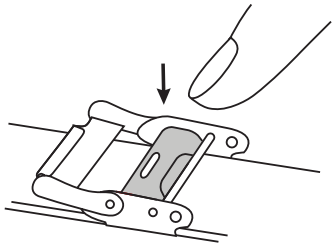
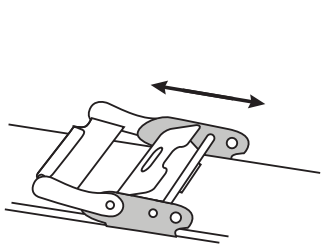

2. 上下滑动表扣，以调整表带以适合您的手腕尺寸。当表带适合您的手腕时，将表扣背面与网状表带上的相应凹槽对齐。

3. 将槽扣向下按，将其牢固关闭。

## 1. 更新您的套装：

### 更换表带

要取下表带，请将手表正面朝下放在柔软平坦的表面上。将表带杆向左滑动，将表带从手表上拉出。

### 插入新表带

将带销插入左销槽。将带杆滑向左侧。对齐带子，这样当杆松开时，右销“咔”地一声插入右销槽。

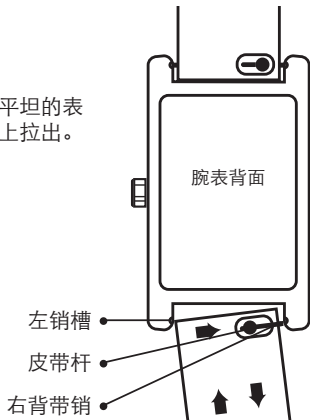

## 2. 更新您的套装：

### 更换表圈

要取下表圈，请逆时针旋转表圈，直到可以从手表上提起表圈。将新表圈放在表壳上，顺时针旋转表圈，直到表圈拧紧。

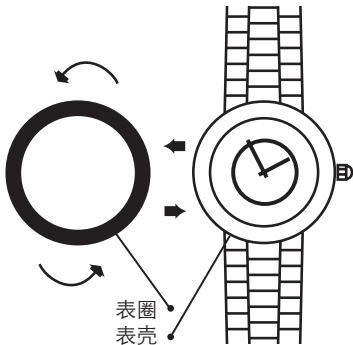

### 3. 更新您的套装：

#### 更换表圈和表带

要取下表圈，请逆时针转动表圈，直到可以将表圈从手表上提起。

将手表竖直放置并解开手链。挂上新的手链。

将新的表圈放在表壳上，并顺时针旋转表圈，直至表圈拧紧。

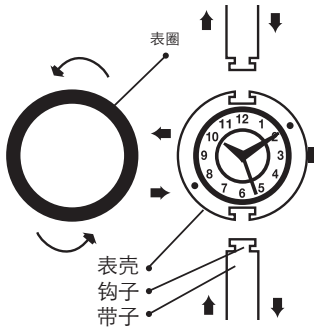

**尊敬的顾客：**

帮助您手表/珠宝零售商保护环境，妥善回收您手表中的纽扣电池。专业珠宝商和手表零售商最有能力更换您手表中的电池，而不会损坏表壳和内部机芯。他们拥有专业工具和经验，可以正确完成这项工作。没有经验的人可能会划伤表壳并损坏防水密封 - 导致您的保修失效。以环保的方式回收手表电池非常重要。手表电池含有极少量的汞，这是防止电池腐蚀和损坏手表所必需的。由于汞在密封的电池中，因此不会对您或您的手表造成危险。但您需要妥善回收手表电池。您的专业手表/珠宝零售商是最适合为您做这件事的人。这些专业人员收集废旧电池并通过有执照的废物管理公司进行回收。

为我们的环境和您的手表出一份力。电池耗尽时，请您的手表/珠宝专业人士更换电池。

需要 (1) 氧化银 (1.55 伏) 电池

如需退回手表进行维修：请将其退回至 ANNE KLEIN WATCH CO. 或授权服务中心；请勿退回至购买地点。

将您的手表小心地包装在一个坚固的盒子中（请勿寄送礼品盒，否则将不会被退回）并邮寄至：

**ANNE KLEIN WATCHES**  
**6015 Little Neck Parkway**  
**Little Neck, NY 11362**  
**ATTN: Service Dept.**  
**Tel: +1 718 482-4195**  
**Email: [servicedept@egluck.com](mailto:servicedept@egluck.com)**

## 授权服务中心：

Clarity Ltd.  
Flat A-B, 12/F,  
Sing Mei Industrial Building  
29-37 Kwai Wing Road  
Kwai Chung, N.T. Hong Kong  
Tel: 852.2424.2211  
Fax: 852.2424.2077  
Email: [senrice@egc-clarity.com](mailto:senrice@egc-clarity.com)

Baode Watch (Shen Zhen) Co. Ltd  
3/F, 56 Mei Bao Road, Xin Qiao Tang  
Ind. Zone, Da Lang, Longhua  
District, Shenzhen, China 518109  
Tel: 86 755-28112770

由于可能出现丢失，我们建议您在邮寄时为手表投保，并要求提供回执。如果您的腕表需要清洁、润滑、更换电池或更换表镜，您所在地区可能设有 ANNE KLEIN 认可的服务中心。这些维修设施使用 ANNE KLEIN 零件和组件来确保质量和未来性能。如果您需要不在保修范围内的服务或维修，我们可以提前提供免费估价。保修范围内的维修可能需要购买凭证，因此请保留购买收据。有关 ANNE KLEIN 批准的服务站和地点的更多信息，请致电上面列出的服务中心。

## 2 年有限保修

这款 ANNE KLEIN 手表为拥有者提供 2 年质保，针对所有材料或工艺缺陷。此质保不适用于正常磨损或滥用，也不包括电池、表壳、表带、水晶或表链。如果在此期间内机芯出现缺陷或故障，我们将选择维修或更换。除非由于我们无法控制的原因（例如事故、误用、疏忽或需要更换不在质保范围内的部件（例如表壳、水晶、表带、表链或电池））需要额外维修，否则不会收取额外费用。在这种情况下，将收取适度费用。

上述补救措施是排他性的。ANNE KLEIN 不对任何偶然或间接损失负责。如果您手表的任何其他部件需要维修，请使用我们的服务中心快速且廉价地维修您的手表。此保修赋予您特定的合法权利，您可能还拥有其他权利，但这些权利可能因国家/地区而异。

EU Representative: 24hour-AR  
Van Nelleweg 1  
3044 BC Rotterdam  
The Netherlands  
compliance@24hour-ar.com

UK Representative: 24hour-AR  
15 Beaufort Court Admirals Way  
Canary Wharf, London  
United Kingdom E14 9XL  
compliance@24hour-ar.com

\* 由于产品改进，规格如有变更，恕不另行通知，设计可能因型号不同而有所差异。





**ANNE KLEIN**

**WATCH INSTRUCTIONS &  
2-YEAR LIMITED WARRANTY**

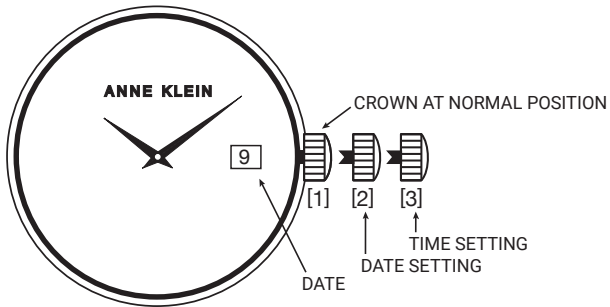

## **SETTING THE TIME**

Pull out Crown all the way until it stops (position '3'). The second hand will stop. Rotate the Crown in either direction until desired time is obtained. Push Crown back in all the way (position '1') to re-engage time keeping. Second hand will begin to move.

***NOTE: Never pull the Crown when the watch is wet.***

## **SETTING THE TIME, DAY AND DATE**

If your watch has a Date or a Day and Date Window, pull the Crown out to position '2' and turn the Crown in both directions until the Date showing is the day before the desired Date. Pull out Crown all the way (position '3') and turn the Crown to advance time. When midnight is reached, the Date will advance to the desired Date. Continue to turn the Crown until desired time is obtained. Push the Crown back in all the way until it stops (position '1') to re-engage time keeping.

## **WATER RESISTANCE**

If your watch is water resistant, the watch is tested to be water resistant to 3-5 atmospheres (100-165 feet).

***NOTE: Over time, the gaskets of the case may become worn and reduce the water resistance of the watch. A trained specialist should change the gaskets and the O-ring each time the battery is changed. To avoid any unwanted condensation, watches of all specifications (water resistant or not) should not be exposed to extreme temperatures such as cold or heat.***

## **CHANGING THE BATTERY**

Replace batteries when the watch becomes slow or does not operate, the readout darkens or does not appear or the backlight fails. Replace with same or equivalent.

***NOTE: Battery change should be performed by a qualified technician who should also check the condition of the gaskets at the same time.***

**BATTERIES ARE NOT COVERED UNDER WARRANTY.**

## DIAGRAMS FOR ADJUSTABLE BRACELET WATCHES

### 1. CLASP EXTENDER

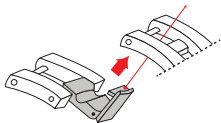

### 2. ONE SCREW SYSTEM

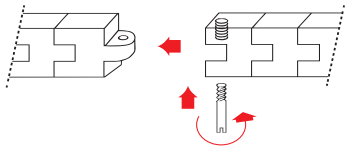

### 3. TWO SCREW SYSTEM

Screw in one at a time

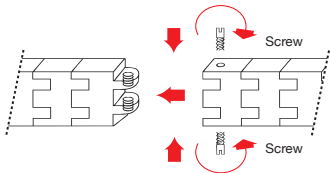

### 4. CONNECTION SYSTEM

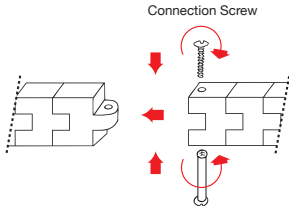

Use 2 screwdrivers. Hold one side steady before turning the screw.

## 5. METAL INSERT

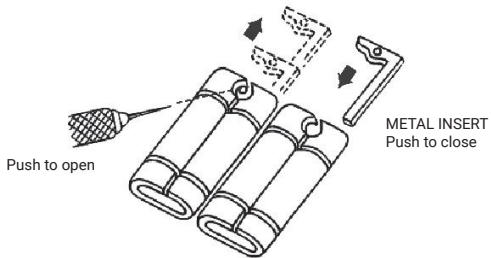

## 6. HAIRCLIP PIN

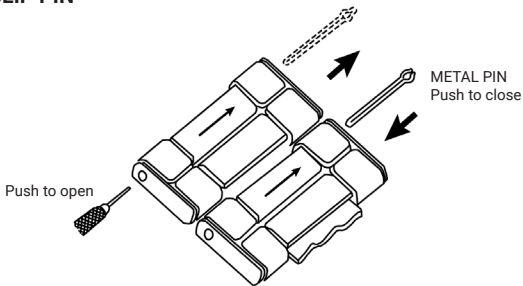

Turn over the watch to look for arrows on the underside of the links, showing you which way you need to push the pin out of the link. Use a pin remover tool to push out the "hair clip pin" from the hole located on the side of the link. After the links are removed, simply follow these steps in reverse to re-assemble the bracelet.

## 7. PIN & TUBE 1



Side view "B" of Link



Side view "A" of Link

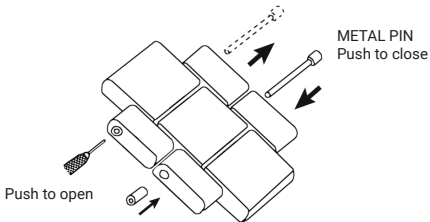

Check the side edge of the watch link, to determine which side of the link is "A" or "B". Take a pin remover tool and push out the pin from the hole located on side "B". After the desired links are removed, simply follow these steps in reverse to re-assemble the bracelet.

## 8. PIN & TUBE 2

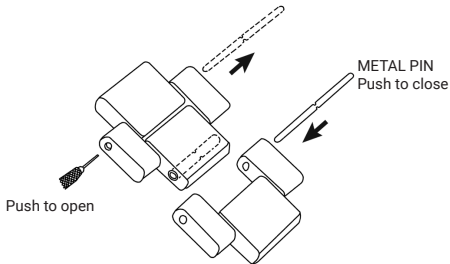

In order to adjust links for this watch construction, you must switch the pin on the tool kit to the longest pin (approximately 10mm long) found under the tool kit. Then use the pin remover tool to push out the pins from either side of the links. After the desired links are removed, simply follow these steps in reverse to re-assemble the bracelet.

## 9. SLIDING BAR

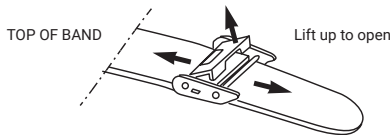

Slide along for adjustment  
(Push down when done)

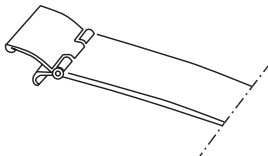
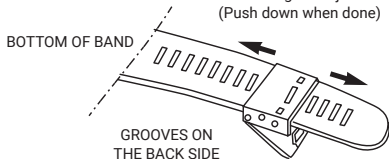

Align protruded line inside the sliding part with desired groove in band

## 10. FOLD-OVER BUCKLE

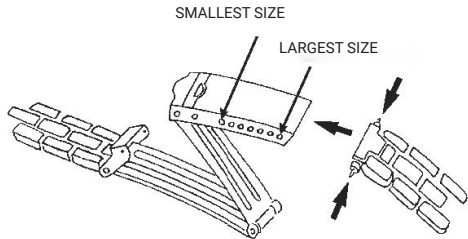

Compress the push pin, and put the ends into the suitable holes along the buckle.

## 11. MESH BAND ADJUSTMENT

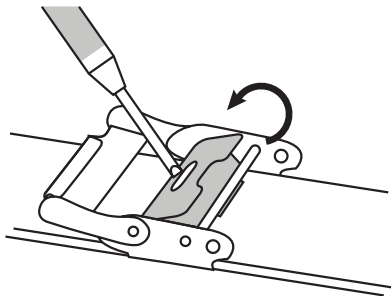

1. Place the tip of a small screwdriver or adjustment tool into the slot on the clasp. Gently exert pressure down on the screwdriver and pry the top portion on the clasp open.

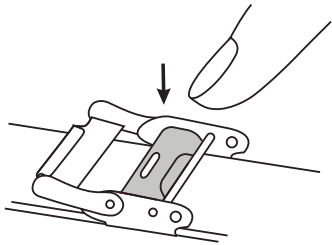
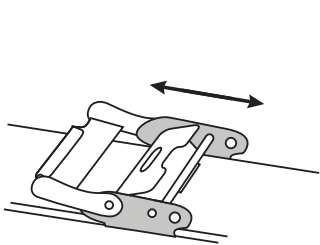

2. Slide the clasp up or down the mesh strap to adjust the band for the size of your wrist. When the proper fit for your wrist has been obtained, align the back of the clasp with the corresponding groove in the mesh watch strap.
3. Press the slotted clasp back down to securely close it.

## 1. TO UPDATE YOUR BOXSET:

### CHANGING THE STRAPS

To remove the Strap, place the watch face down on a soft, flat surface. Slide the Strap Lever to the left and pull the Strap away from the watch.

### TO INSERT THE NEW STRAP

Set Strap Pin into the Left Pin Groove. Slide the Strap Lever to the left. Align the Strap so the Right Pin “clicks” into the Right Pin Groove when the Lever is released.

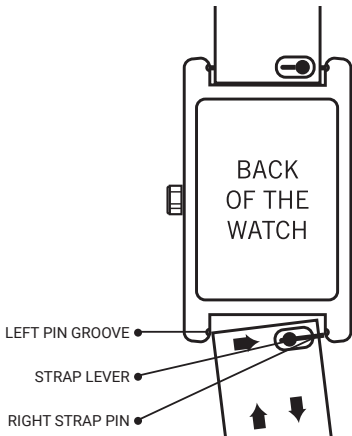

## 2. TO UPDATE YOUR BOXSET:

### CHANGING THE BEZEL

To remove the Bezel, turn the Bezel counterclockwise until you can lift the Bezel from the watch. Place the new Bezel over the Watch Case and turn the Bezel clockwise until the Bezel is tight.

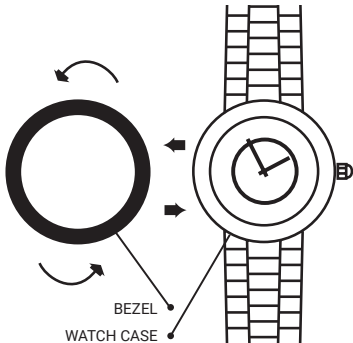

### 3. TO UPDATE YOUR BOXSET:

#### CHANGING THE BEZEL AND BRACELET

To remove the Bezel, turn the Bezel counterclockwise until you can lift the Bezel from the watch.

Hold the Watch upright and unhook the Bracelet. Hook on the new Bracelet.

Place the new Bezel over the Watch Case and turn the Bezel clockwise until the Bezel is tight.

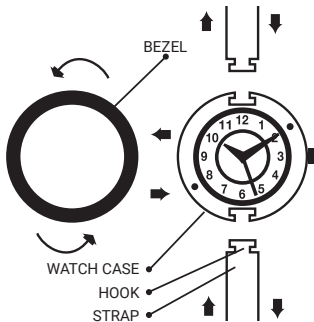

**Dear Customer:**

Help your watch/jewelry retailer protect our environment by properly recycling the button cell battery in your watch. Professional jewelers and watch retailers are best equipped to replace the battery in your watch without damage to the watch case and movement inside. They have the specialized tools and experience to do the job right. Inexperienced people can scar the case and damage the water resistant seal – voiding your warranty. It is important to recycle your watch battery in an environmentally safe way. Watch batteries contain very small amounts of mercury, which is required to prevent corrosion of the battery and damage to your watch. There is no danger to you or your watch from the mercury because it is in the sealed battery. But you need to recycle your watch battery properly. Your professional watch/jewelry retailer is the best person to do this for you. These professionals collect used batteries and recycle them through licensed waste management companies.

Do our environment and your watch a favor. Ask your watch/jewelry professional to replace your battery when it expires.

Requires (1) silver oxide (1.55 volt) battery included

**TO RETURN YOU WATCH FOR SERVICING: RETURN IT TO ANNE KLEIN CO. OR TO AN AUTHORIZED SERVICE CENTER; IT SHOULD NOT BE RETURNED TO PLACE OF PURCHASE.**

Carefully pack you watch in a sturdy box (do not send in a gift box for same will not be returned) and mail to:

ANNE KLEIN WATCHES

6015 Little Neck Parkway  
Little Neck, NY 11362

ATTN: Service Dept.

Tel: +1 718 482-4195

Email: [servicedept@egluck.com](mailto:servicedept@egluck.com)

Clarity Ltd.

Flat A- B, 12/F,  
Sing Mei Industrial Building  
29-37 Kwai Wing Road  
Kwai Chung, N.T. Hong Kong

Tel: 852.2424.2211

Fax: 852.2424.2077

Email: [service@egc-clarity.com](mailto:service@egc-clarity.com)

Because of possible loss, we recommend that you insure your watch, return receipt requested, when using the mail. If your watch requires cleaning, lubrication, battery changing, or needs a crystal replaced, ANNE KLEIN approved Service Centers may be available in your area. These repair facilities use ANNE KLEIN parts and components to assure quality and future performance. Free estimates are available in advance, should you need servicing or repairs not covered under the warranty. Repairs covered under the warranty may require proof of purchase, so retain the purchase receipt. For further information regarding ANNE KLEIN approved Service Stations and locations, please call the Service Centers listed above.

## **2 YEAR LIMITED WARRANTY**

This Anne Klein Watch is warranted to you, the owner, for 2 years against all defects in material or workmanship. This warranty does not apply to normal wear and tear or abuse and excludes batteries, case, strap, crystal, or bracelet. In the event of a defect or malfunction of the movement within this period it will be repaired or replaced, at our option. No additional charge will be made unless additional servicing is necessary for reasons beyond our control such as accident, misuse, neglect or replacement of parts not warranted is required such as case, crystal, strap, bracelet or batteries in which event a moderate charge will be made.

The aforementioned remedy is exclusive. ANNE KLEIN shall not be liable for any incidental or consequential damages. Should any other part of your watch require repair, please use our Service Centers for quick and inexpensive repairs on your watch. This warranty gives you specific legal rights and you may also have other rights which may vary from country to country.

EU Representative: 24hour-AR  
Van Nelleweg 1  
3044 BC Rotterdam  
The Netherlands  
compliance@24hour-ar.com

UK Representative: 24hour-AR  
15 Beaufort Court Admirals  
Way Canary Wharf, London  
United Kingdom E14 9XL  
compliance@24hour-ar.com

\* SPECIFICATIONS SUBJECT TO CHANGE WITHOUT PRIOR NOTICE FOR PRODUCT  
IMPROVEMENT, DESIGN MAY VARY DEPENDING ON THE MODEL.

