

ANNE KLEIN

手錶說明書和 2 年保修期

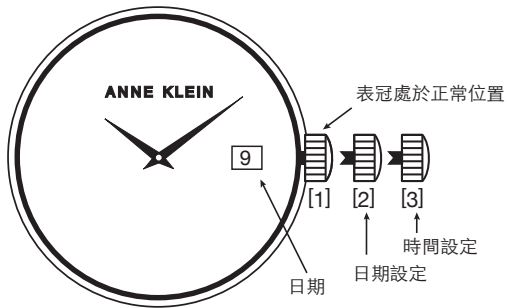

設置時間

將表冠完全拉出，直至其停止（位置“3”）。秒針將停止。向任一方向旋轉表冠，直到獲得所需的時間。將表冠完全推回（位置“1”）以重新計時。秒針將開始移動。

注意：手錶潮濕時切勿拉動表冠。

設置時間、星期和日期

如果您的手錶有時間、星期和日期窗口，請將表冠拉出至位置“2”，並向兩個方向旋轉表冠，直到顯示的日期為所需日期的前一天。將表冠完全拉出（位置“3”）並旋轉表冠以推進時間。到達午夜時分，日期將推進至所需日期。繼續旋轉表冠，直到獲得所需時間。將表冠完全推回，直至其停止（位置“1”）以重新開始計時。

防水性能

如果您的手錶具有防水功能，則該手錶經過測試可防水 3-5 個大氣壓（100-165 英尺）。

注意：隨著時間的推移，表殼的墊圈可能會磨損，從而降低手錶的防水性。每次更換電池時，應由訓練有素的專業人員更換墊圈和 O 形圈。為避免任何不必要的冷凝，所有規格的手錶（防水或非防水）都不應暴露在極端溫度下，例如寒冷或的極端溫度。

更換電池

當手錶走時緩慢或不走動、讀數變暗或不顯示、背光燈失效時，請更換電池。更換相同或同等電池。

注意：電池更換應由合格的技術人員進行，同時還應檢查墊圈的狀況。電池不在保修範圍內。

可調式手鏈手錶圖表

1. 卡扣延長器

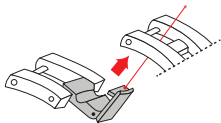

2. 單螺釘系統

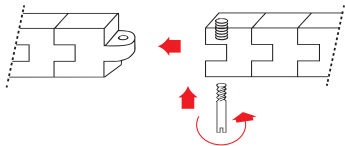

3. 雙螺桿系統

每次擰入一顆螺絲。

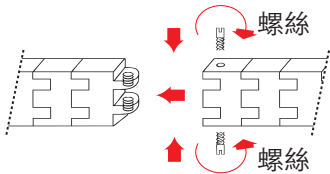

4. 連接系統

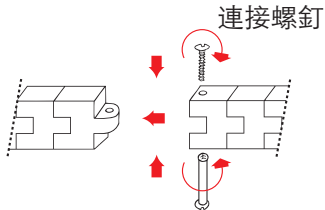

使用 2 把螺絲刀。擰動螺絲之前先握住一側，使其穩定。

5. 金屬嵌件

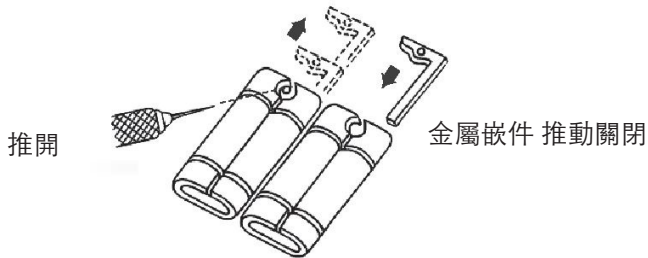

6. 髮夾銷釘

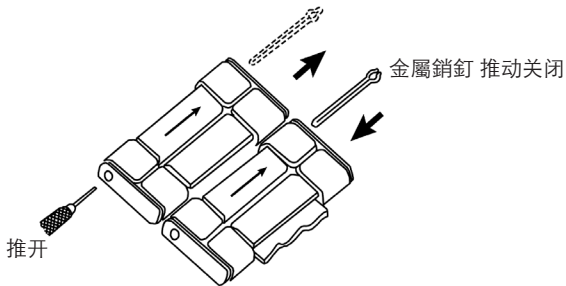

翻轉手錶，查看鏈節下方的箭頭，箭頭會顯示需要將銷釘從鏈節中推出的方向。使用銷釘拆卸工具將“髮夾銷釘”從鏈節側面的孔中推出。鏈節拆卸後，只需按相反順序執行這些步驟即可重新組裝錶鏈。

7. 銷釘和管套1



鏈節“B”側视图



鏈節“A”側视图

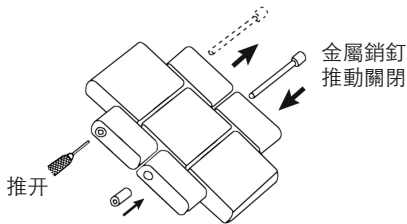

檢查手錶鏈節的側邊，確定鏈節的哪一側是“A”或“B”。使用銷釘拆卸工具，將銷釘從位於“B”側的孔中推出。拆卸所需鏈節後，只需按相反步驟操作即可重新組裝錶鏈。

8. 銷釘和管套 2

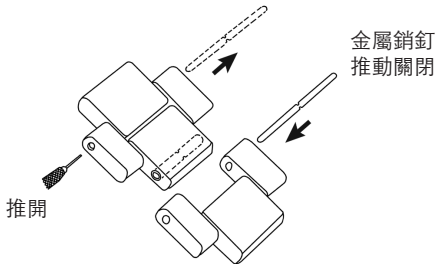

為了調整此手錶結構的鏈節，您必須切換將工具箱中的最長銷釘（約 10 毫米長）插入工具箱下方。然後使用銷釘拆卸工具將銷釘從鏈環的兩側推出。拆卸所需鏈環後，只需按相反步驟操作即可重新組裝手鏈。

9. 滑動條

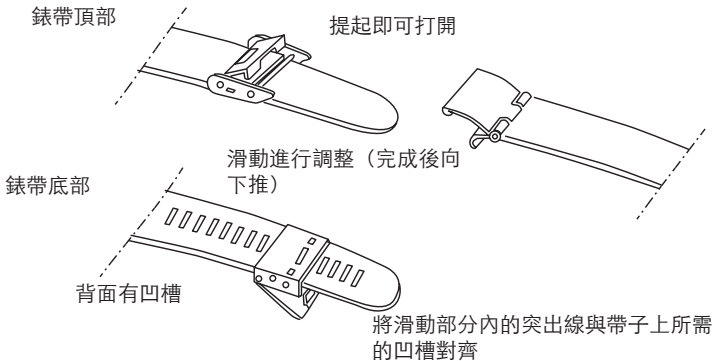

10. 折疊扣

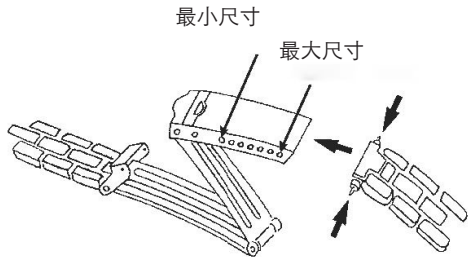

壓縮圖釘，並將其末端插入沿著扣環的合適孔中。

網格帶調節

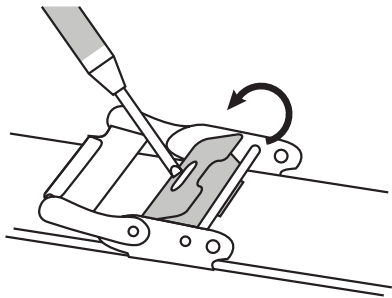

1.將小型螺絲刀或調節工具的尖端插入扣環上的插槽。
將扣環的頂部撬開。

輕輕地用力按下螺絲刀，

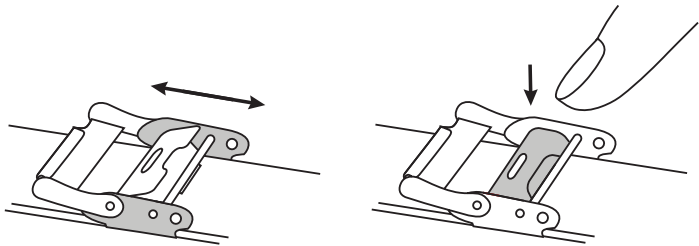

2.上下滑動表扣，以調整錶帶以適合您的手腕尺寸。當錶帶適合您的手腕時，將表扣背面與網狀錶帶上的相應凹槽對齊。

3. 將槽扣向下按，將其牢固關閉。

1.更新您的套裝：

更換錶帶

要取下錶帶，請將手錶正面朝下放在柔軟平坦的表面上。將錶帶杆向左滑動，將錶帶從手錶上拉出。

插入新錶帶

將帶銷插入左銷槽。將帶杆滑向左側。對齊帶子，這樣當杆鬆開時，右銷“啉”地一聲插入右銷槽。

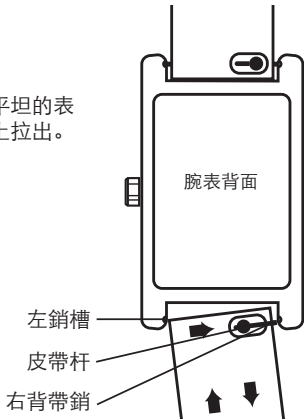

2. 更新您的套裝：

更換表圈

要取下表圈，請逆時針旋轉表圈，直到可以從手錶上提起表圈。將新表圈放在表殼上，順時針旋轉表圈，直到表圈擰緊。

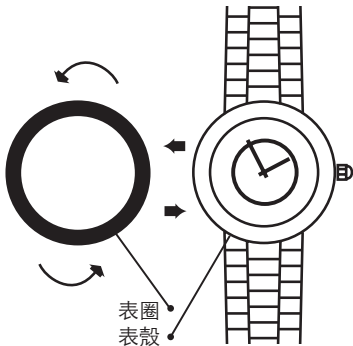

3. 更新您的套裝：

更換表圈和錶帶

要取下表圈，請逆時針轉動表圈，直到可以將表圈從手錶上提起。

將手錶豎直放置並解開手鍊。掛上新的手鍊。

將新的表圈放在表殼上，並順時針旋轉表圈，直至表圈擰緊。

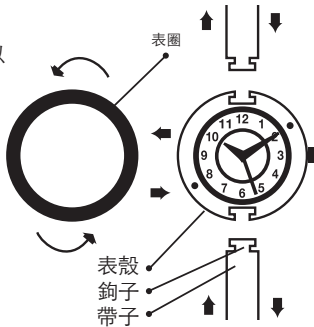

尊敬的顧客：

幫助您的手錶/珠寶零售商保護環境，妥善回收您手錶中的鈕扣電池。專業珠寶商和手錶零售商最有能力更換您手錶中的電池，而不會損壞表殼和內部機芯。他們擁有專業工具和經驗，可以正確完成這項工作。沒有經驗的人可能會劃傷表殼並損壞防水密封 - 導致您的保修失效。以環保的方式回收手錶電池非常重要。手錶電池含有極少量的汞，這是防止電池腐蝕和損壞手錶所必需的。由於汞在密封的電池中，因此不會對您或您的手錶造成危險。但您需要妥善回收手錶電池。您的專業手錶/珠寶零售商是最適合為您做這件事的人。這些專業人員收集廢舊電池並通過有執照的廢物管理公司進行回收。

為我們的環境和您的手錶出一份力。電池耗盡時，請您的手錶/珠寶專業人士更換電池。

需要 (1) 氧化銀 (1.55 伏) 電池

如需退回手錶進行維修：請將其退回至 ANNE KLEIN WATCH CO. 或授權服務中心；請勿退回至購買地點。

將您的手錶小心地包裝在一個堅固的盒子中（請勿寄送禮品盒，否則將不會被退回）並郵寄至：

ANNE KLEIN WATCHES
6015 Little Neck Parkway
Little Neck, NY 11362
ATTN: Service Dept.
Tel: +1 718 482-4195
Email: servicedept@egluck.com

授權服務中心：

Clarity Ltd.
Flat A-B, 12/F,
Sing Mei Industrial Building
29-37 Kwai Wing Road
Kwai Chung, N.T. Hong Kong
Tel: 852.2424.2211
Fax: 852.2424.2077
Email: senrice@egc-clarity.com

Baode Watch (Shen Zhen) Co. Ltd
3/F, 56 Mei Bao Road, Xin Qiao Tang
Ind. Zone, Da Lang, Longhua
District, Shenzhen, China 518109
Tel: 86 755-28112770

由於可能出現丟失，我們建議您在郵寄時為手錶投保，並要求提供回執。如果您的腕表需要清潔、潤滑、更換電池或更換表鏡，您所在地區可能設有 ANNE KLEIN 認可的服務中心。這些維修設施使用 ANNE KLEIN 零件和組件來確保品質和未來性能。如果您需要不在保修範圍內的服務或維修，我們可以提前提供免費估價。保修範圍內的維修可能需要購買憑證，因此請保留購買收據。有關 ANNE KLEIN 批准的服務站和地點的更多資訊，請致電上面列出的服務中心。

2 年有限保修

這款 ANNE KLEIN 手錶為擁有者提供 2 年質保，針對所有材料或工藝缺陷。此質保不適用於正常磨損或濫用，也不包括電池、表殼、錶帶、水晶或錶鏈。如果在此期間內機芯出現缺陷或故障，我們將選擇維修或更換。除非由於我們無法控制的原因（例如事故、誤用、疏忽或需要更換不在質保範圍內的部件（例如表殼、水晶、錶帶、錶鏈或電池））需要額外維修，否則不會收取額外費用。在這種情況下，將收取適度費用。

上述補救措施是排他性的。ANNE KLEIN 不對任何偶然或間接損失負責。如果您手錶的任何其他部件需要維修，請使用我們的服務中心快速且廉價地維修您的手錶。此保修賦予您特定的合法權利，您還可能擁有其他權利，但這些權利可能因國家/地區而異。

EU Representative: 24hour-AR
Van Nelleweg 1
3044 BC Rotterdam
The Netherlands
compliance@24hour-ar.com

UK Representative: 24hour-AR
15 Beaufort Court Admirals Way
Canary Wharf, London
United Kingdom E14 9XL
compliance@24hour-ar.com

* 由於產品改進，規格如有變更，恕不另行通知，設計可能因型號不同而有所差異。





ANNE KLEIN

**WATCH INSTRUCTIONS &
2-YEAR LIMITED WARRANTY**

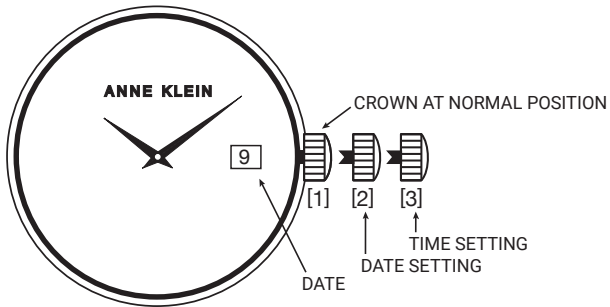

SETTING THE TIME

Pull out Crown all the way until it stops (position '3'). The second hand will stop. Rotate the Crown in either direction until desired time is obtained. Push Crown back in all the way (position '1') to re-engage time keeping. Second hand will begin to move.

NOTE: Never pull the Crown when the watch is wet.

SETTING THE TIME, DAY AND DATE

If your watch has a Date or a Day and Date Window, pull the Crown out to position '2' and turn the Crown in both directions until the Date showing is the day before the desired Date. Pull out Crown all the way (position '3') and turn the Crown to advance time. When midnight is reached, the Date will advance to the desired Date. Continue to turn the Crown until desired time is obtained. Push the Crown back in all the way until it stops (position '1') to re-engage time keeping.

WATER RESISTANCE

If your watch is water resistant, the watch is tested to be water resistant to 3-5 atmospheres (100-165 feet).

NOTE: Over time, the gaskets of the case may become worn and reduce the water resistance of the watch. A trained specialist should change the gaskets and the O-ring each time the battery is changed. To avoid any unwanted condensation, watches of all specifications (water resistant or not) should not be exposed to extreme temperatures such as cold or heat.

CHANGING THE BATTERY

Replace batteries when the watch becomes slow or does not operate, the readout darkens or does not appear or the backlight fails. Replace with same or equivalent.

NOTE: Battery change should be performed by a qualified technician who should also check the condition of the gaskets at the same time.

BATTERIES ARE NOT COVERED UNDER WARRANTY.

DIAGRAMS FOR ADJUSTABLE BRACELET WATCHES

1. CLASP EXTENDER

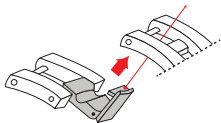

2. ONE SCREW SYSTEM

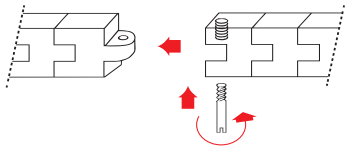

3. TWO SCREW SYSTEM

Screw in one at a time

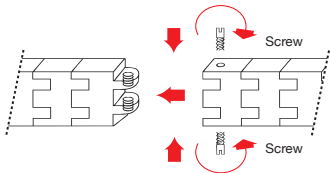

4. CONNECTION SYSTEM

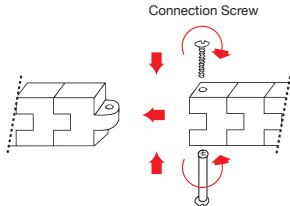

Use 2 screwdrivers. Hold one side steady before turning the screw.

5. METAL INSERT

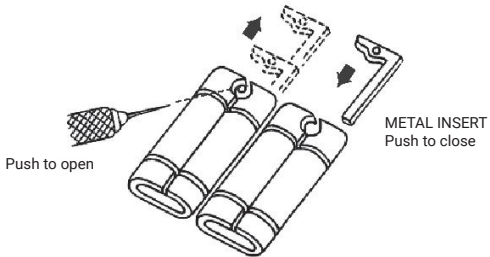

6. HAIRCLIP PIN

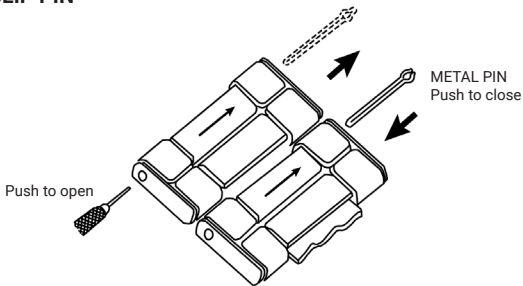

Turn over the watch to look for arrows on the underside of the links, showing you which way you need to push the pin out of the link. Use a pin remover tool to push out the "hair clip pin" from the hole located on the side of the link. After the links are removed, simply follow these steps in reverse to re-assemble the bracelet.

7. PIN & TUBE 1



Side view "B" of Link



Side view "A" of Link

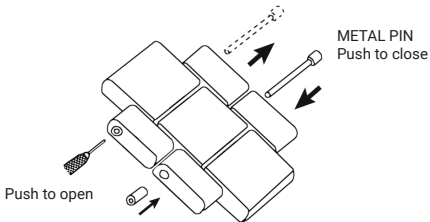

Check the side edge of the watch link, to determine which side of the link is "A" or "B". Take a pin remover tool and push out the pin from the hole located on side "B". After the desired links are removed, simply follow these steps in reverse to re-assemble the bracelet.

8. PIN & TUBE 2

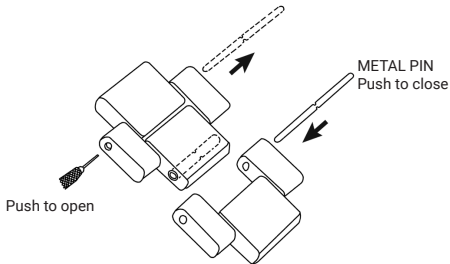

In order to adjust links for this watch construction, you must switch the pin on the tool kit to the longest pin (approximately 10mm long) found under the tool kit. Then use the pin remover tool to push out the pins from either side of the links. After the desired links are removed, simply follow these steps in reverse to re-assemble the bracelet.

9. SLIDING BAR

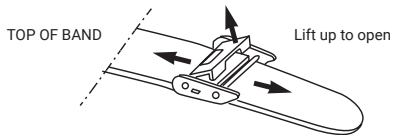

Slide along for adjustment
(Push down when done)

BOTTOM OF BAND

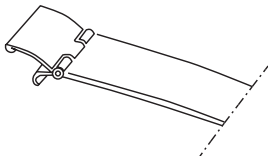
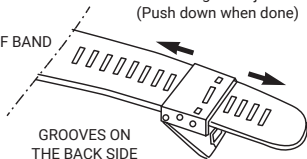

Align protruded line inside the sliding part with desired groove in band

10. FOLD-OVER BUCKLE

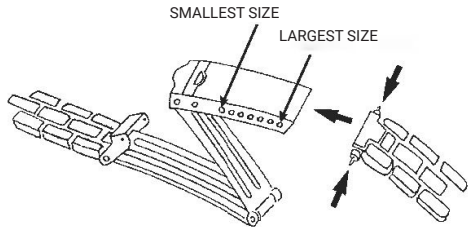

Compress the push pin, and put the ends into the suitable holes along the buckle.

11. MESH BAND ADJUSTMENT

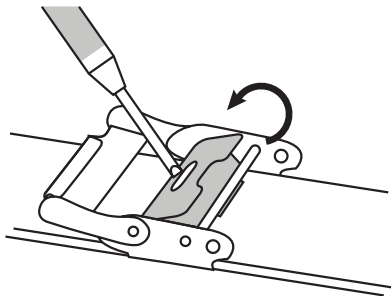

1. Place the tip of a small screwdriver or adjustment tool into the slot on the clasp. Gently exert pressure down on the screwdriver and pry the top portion on the clasp open.

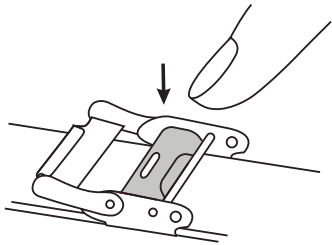
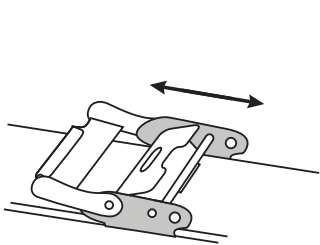

2. Slide the clasp up or down the mesh strap to adjust the band for the size of your wrist. When the proper fit for your wrist has been obtained, align the back of the clasp with the corresponding groove in the mesh watch strap.

3. Press the slotted clasp back down to securely close it.

1. TO UPDATE YOUR BOXSET:

CHANGING THE STRAPS

To remove the Strap, place the watch face down on a soft, flat surface. Slide the Strap Lever to the left and pull the Strap away from the watch.

TO INSERT THE NEW STRAP

Set Strap Pin into the Left Pin Groove. Slide the Strap Lever to the left. Align the Strap so the Right Pin “clicks” into the Right Pin Groove when the Lever is released.

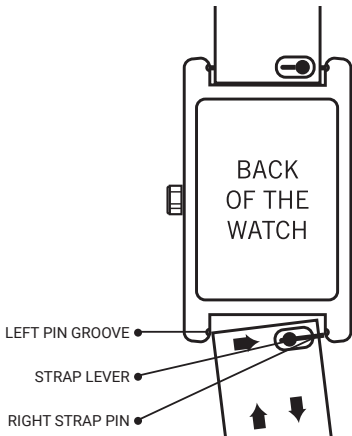

2. TO UPDATE YOUR BOXSET:

CHANGING THE BEZEL

To remove the Bezel, turn the Bezel counterclockwise until you can lift the Bezel from the watch. Place the new Bezel over the Watch Case and turn the Bezel clockwise until the Bezel is tight.

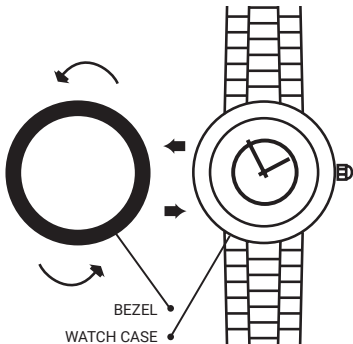

3. TO UPDATE YOUR BOXSET:

CHANGING THE BEZEL AND BRACELET

To remove the Bezel, turn the Bezel counterclockwise until you can lift the Bezel from the watch.

Hold the Watch upright and unhook the Bracelet. Hook on the new Bracelet.

Place the new Bezel over the Watch Case and turn the Bezel clockwise until the Bezel is tight.

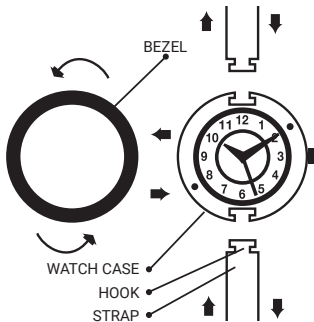

Dear Customer:

Help your watch/jewelry retailer protect our environment by properly recycling the button cell battery in your watch. Professional jewelers and watch retailers are best equipped to replace the battery in your watch without damage to the watch case and movement inside. They have the specialized tools and experience to do the job right. Inexperienced people can scar the case and damage the water resistant seal – voiding your warranty. It is important to recycle your watch battery in an environmentally safe way. Watch batteries contain very small amounts of mercury, which is required to prevent corrosion of the battery and damage to your watch. There is no danger to you or your watch from the mercury because it is in the sealed battery. But you need to recycle your watch battery properly. Your professional watch/jewelry retailer is the best person to do this for you. These professionals collect used batteries and recycle them through licensed waste management companies.

Do our environment and your watch a favor. Ask your watch/jewelry professional to replace your battery when it expires.

Requires (1) silver oxide (1.55 volt) battery included

TO RETURN YOUR WATCH FOR SERVICING: RETURN IT TO ANNE KLEIN CO. OR TO AN AUTHORIZED SERVICE CENTER; IT SHOULD NOT BE RETURNED TO PLACE OF PURCHASE.

Carefully pack your watch in a sturdy box (do not send in a gift box for same will not be returned) and mail to:

ANNE KLEIN WATCHES

6015 Little Neck Parkway
Little Neck, NY 11362

ATTN: Service Dept.

Tel: +1 718 482-4195

Email: servicedept@egluck.com

Clarity Ltd.

Flat A- B, 12/F,
Sing Mei Industrial Building
29-37 Kwai Wing Road
Kwai Chung, N.T. Hong Kong

Tel: 852.2424.2211

Fax: 852.2424.2077

Email: service@egc-clarity.com

Because of possible loss, we recommend that you insure your watch, return receipt requested, when using the mail. If your watch requires cleaning, lubrication, battery changing, or needs a crystal replaced, ANNE KLEIN approved Service Centers may be available in your area. These repair facilities use ANNE KLEIN parts and components to assure quality and future performance. Free estimates are available in advance, should you need servicing or repairs not covered under the warranty. Repairs covered under the warranty may require proof of purchase, so retain the purchase receipt. For further information regarding ANNE KLEIN approved Service Stations and locations, please call the Service Centers listed above.

2 YEAR LIMITED WARRANTY

This Anne Klein Watch is warranted to you, the owner, for 2 years against all defects in material or workmanship. This warranty does not apply to normal wear and tear or abuse and excludes batteries, case, strap, crystal, or bracelet. In the event of a defect or malfunction of the movement within this period it will be repaired or replaced, at our option. No additional charge will be made unless additional servicing is necessary for reasons beyond our control such as accident, misuse, neglect or replacement of parts not warranted is required such as case, crystal, strap, bracelet or batteries in which event a moderate charge will be made.

The aforementioned remedy is exclusive. ANNE KLEIN shall not be liable for any incidental or consequential damages. Should any other part of your watch require repair, please use our Service Centers for quick and inexpensive repairs on your watch. This warranty gives you specific legal rights and you may also have other rights which may vary from country to country.

EU Representative: 24hour-AR
Van Nelleweg 1
3044 BC Rotterdam
The Netherlands
compliance@24hour-ar.com

UK Representative: 24hour-AR
15 Beaufort Court Admirals
Way Canary Wharf, London
United Kingdom E14 9XL
compliance@24hour-ar.com

* SPECIFICATIONS SUBJECT TO CHANGE WITHOUT PRIOR NOTICE FOR PRODUCT
IMPROVEMENT, DESIGN MAY VARY DEPENDING ON THE MODEL.

